

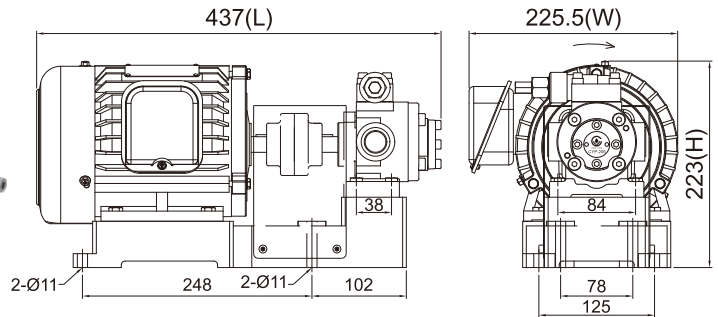

CHEN YING

Horizontal Motor + Connector + Heavy Oil Pump



Horizontal Motor with Cast Iron Frame + Connector + Heavy Oil Pump

◆ Features:

1. It can steady provides oil.
2. It is easy to operate and install.
3. The discharge volume and pressure is bigger than the rotary oil pump.
4. Recommend to assemble with an adjustable valve and working pressure under 10 kgf/cm² in order to avoid damaging oil pump function.
5. Use clean oil to avoid the block or damage the pump.
6. The connector can help to reduce the noise while the motor is operating. It also can make the shaft much more durable. With a dust-shelter for the safety concern.
7. 1/2HP and 1HP TECO motor are available on request. Please mark ※M while ordering.
8. The proper oil viscosity is 32~220cSt@40°C
9. Recommend to install an Oil Auto Cleaner or a Line Filter to prevent any impurities from clogging or causing damage to the heavy oil pump in order to prolong the life cycle of heavy oil pump.

◆ Application:

1. Heavy oil pump can supply oil steadily, and be operated easily. It can be applied extensively to various different size machines such as industrial machines, tool machines, screw machines, etc.

◆ Recommend to work with the motor as the follows.

Model	Discharge Volume (L/min)		Max Pressure	R.P.M.	Length (mm)	Dis. Bore	Pump Pedestal Holder	
	1420rpm	1720rpm					Distance Between Fixed Holes (mm)	Height (mm)
CYP-204	7.5	9.0	20 kgf/cm ²	450~2000 rpm	141	PT 1/2	84 , 38	134
CYP-206	11.3	13.5			146	PT 3/4		
CYP-208	15.3	18.5			151	PT 3/4		
CYP-210	19.0	23.0			156	PT 3/4		
CYP-212	21.9	26.5			161	PT 1, PT 3/4		
CYP-216	29.3	35.5			171	PT1		
CYP-220	34.3	41.5			181	PT1		

Model	With Adjustable Pressure Valve (Recommendable)	Without Adjustable Pressure Valve
	Motor Type	Motor Type
CYP-204	1/2HP	1HP
CYP-206	1/2HP	1HP
CYP-208	1/2HP	1HP
CYP-210	1/2HP	2HP
CYP-212	1HP	2HP
CYP-216	1HP	2HP
CYP-220	1HP	3HP

◆ Order Code:

CYP-204	1	04	C	※
Model	Adjustable Pressure Valve	Motor	Voltage:	Special Request
204		04 : 1/2HP	A: 1Ø 110V	T: Change the fixed-hole direction of heavy oil pump to /.
206	1: With Adjustable	08 : 1HP	C: 1Ø 220V	M: Change motor to TECO motor.
208	Pressure Valve	16 : 2HP	D: 3Ø 220/380V	Y: Add connector, pump holder, and motor fixed seat.
210		24 : 3HP	E: 3Ø 220/440V	
212	0: Without Adjustable		F: 3Ø 208/415V	
216	Pressure Valve		G: 3Ø 230/460V	
220			H: 3Ø 240/480V	
			X: Special Voltage	

*The standard specification of B Bore for CYP-212 is PT1.

Horizontal Motor + Connector + Heavy Oil Pump